



Radio Frequency Systems' line of high performance coaxial cable connectors are designed specifically to provide the highest quality connector-cable interface while simplifying and speeding up the attachment of connectors to CELLFLEX® coaxial cables. RFS Technologies connectors are fully tested for mechanical and electrical compliance specifications. They are available in all popular cable sizes in a variety of mating interfaces. To join two cables with EIA connectors, two identical socket connectors are installed on either end of the cables to be joined, and a coupling element is used to make the connection of the center conductor. The coupling element must be ordered separately with the exception of the S-Line male versions that have a captivated coupling element. Connectors are available in sizes matching the nominal cable size. EIA connectors provide optimal power handling for the complete transmission line system.



RAPID FIT™ Connectors

FEATURES / BENEFITS

- Single-piece design for Fast and Easy Installation
Reliable and simple attachment avoids unnecessary connector adjustments and provides outstanding performance every time. Saves time and provides cost savings.
- Robust Mechanical Design
Low and consistent intermodulation performance guarantees outstanding system sensitivity.
- Excellent Electrical Performance
Consistent and repeatable low VSWR improves overall system performance and margin and reduces mismatch losses
- Totally Waterproof according to IP 68
Assures safe, long term operation in the harshest of environments.

External Document Links

[Installation Instruction](#)

Notes

¹⁾ The sealing compound must be ordered separately.

Technical features

GENERAL SPECIFICATIONS

Transmission Line Type		Coaxial Cable
Cable Size		7/8
Cable Type		Foam Dielectric
Model Series		LCF78-50A-Series, RCF78-50A-Series
Connector Interface		1-5/8" EIA
Connector Type		RAPID FIT™
Sealing Method		Sealing compound ¹⁾
Gender		None

ELECTRICAL SPECIFICATIONS

3rd Order IM Product @ 2x20 Watts	dBc	<-156
Maximum Frequency	GHz	3.3
VSWR, Return Loss	VSWR (dB)	0 < f ≤ 1.0 GHz: 1.02 (40) 1.0 < f ≤ 2.7 GHz: 1.03 (36.6) 2.7 < f ≤ 3.7 GHz: 1.06 (30.7)



MECHANICAL SPECIFICATIONS

Plating Outer/Inner		Silver/Silver
Length	mm (in)	110 (4.3)
Outer Diameter	mm (in)	90 (3.5)
Inner Contact Attachment		Spring Finger
Outer Contact Attachment		Spring Finger

ACCESSORIES

Wrench size front	mm (in)	30 (1-3/16)
Wrench size rear	mm (in)	30 (1-3/16)
Trimming Tool		TRIM-Series-A

TESTING AND ENVIRONMENTAL

Waterproof Level		IP68
Sealing Volume, cm ³ (ounces)	cm ³ (ounces)	7 (0.26)

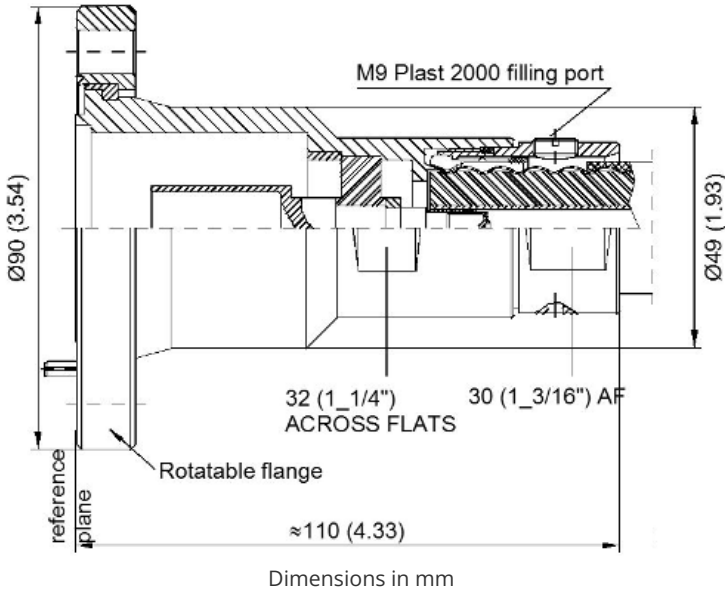

Dimensions in mm